



**ESTRELA
ESTATES**

ELEVATING YOUR EXPERIENCE

THE **IVY**

1 & 2 BHK LUXURIOUS HOMES

THE **IVY**

Pushpak Nagar, Dapoli

Close to Nature



**The True
Art of Living,
Built to Inspire.**

Artist's Impression*

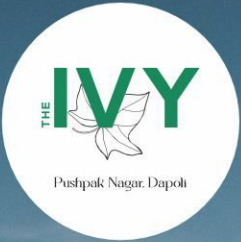

**A Life
Full of View
@ Pushpak
Nagar**

Living with the like-minded, the way you want to lead your life! The IVY, futuristic residential abodes 13 level tower provides you all you need for secure community living. You will be meeting and greeting those of your class and tastes enjoying the lifestyle you prefer. The secure feeling of living in a community comes as an added advantage.



Artist's Impression*



Your Options for Green Living is Here..

The Pristine Mountain will act as a pleasant and silent witness to every single day you spend at Pushpak Nagar, Dapoli. Not just soothing to your eyes; but filling your heart as well. You owe your moments of happiness and relaxation to the calming mountain view and the caressing breeze. No wonder, you will start looking at life from new prospects.

- CIDCO Tender Plot.
- G + 13 storied Residential Cum Commercial Project.
- Aesthetically Designed 1 & 2 BHK Flats.
- Quality Construction with earthquake Resistant RCC Structure
- Excellent Planning with no wastage in all rooms
- Attractively designed Grand Entrance Lobby
- Fully Automatic High speed Elevator
- Ample car parking space
- Round the clock Security
- Project approved by major financial Institutions and Banks



PROJECT AMENITIES

- 1 Swimming Pool
- 2 Fitness Center
- 3 Garden
- 4 Kids Play Area
- 5 Indoor Games
- 6 Seating Area
- 7 Wooden Deck Sit-outs



Artist's Impression*

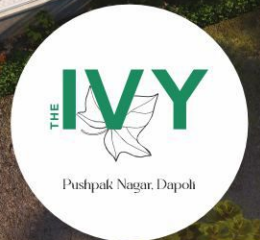



**Open to Sky
Swimming
Pool**



**The Ultimate Luxury is being able to Relax &
Enjoy at Your Home**

Artist's Impression*

Fitness Center

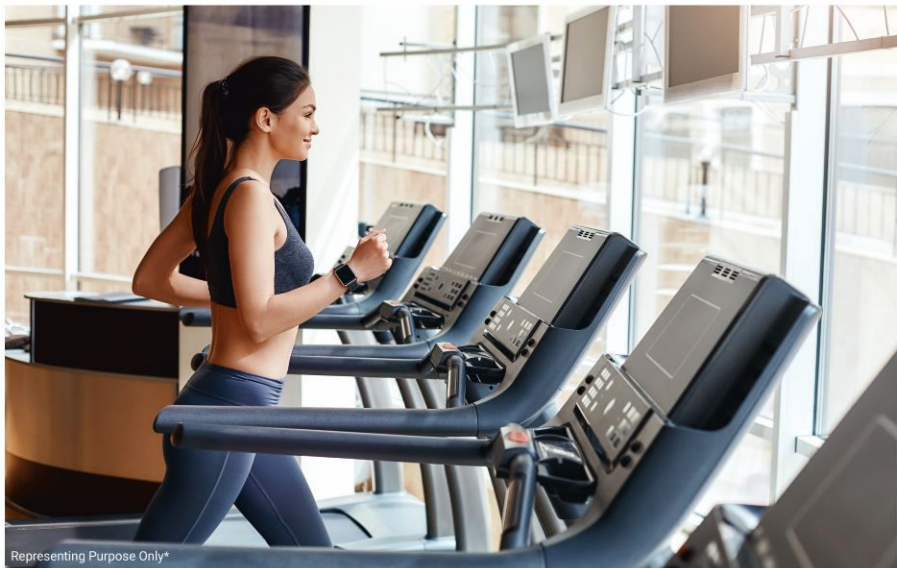

Representing Purpose Only*

Indoor Games



Representing Purpose Only*



Representing Purpose Only*



Representing Purpose Only*

Kids Play Area



Seating Area





ISOMETRIC VIEW
1 BHK Flat



ISOMETRIC VIEW
2 BHK Flat



THE IVY AT A GLANCE

FLOORING :

- Double Vitrified Flooring in all Rooms
- Walls Tiles in Bathroom / Toilet up to Beam Level

KITCHEN :

- Granite Kitchen Platform
- Stainless steel Branded Sink
- Provision for Refrigerator, Mixer, Aquaguard and Exhaust Fan Points

DOORS & WINDOWS :

- Decorative Laminated Flush Main
- Doors with Wooden Frames
- Powder Coated Aluminium Sliding
- Windows with one way Glass
- Marble Windows Sills

BATH & WC :

- Concealed Plumbing with premium Quality CP Fittings
- Provision for Hot water geyser Point in all Bathrooms

WALLS :

- Putty / POP finish walls with Acrylic Emulsion Paint
- Pure Acrylic Emulsion Paints to all External walls of Entire Buildings

ELECTRIFICATION :

- Concealed Brand Copper wiring with Modular Switches of ISI Brand. TV, Telephone in Living, AC Point Provision in Bathroom

WATER TANK :

- Underground & overhead Water Tank with Adequate water storage capacity

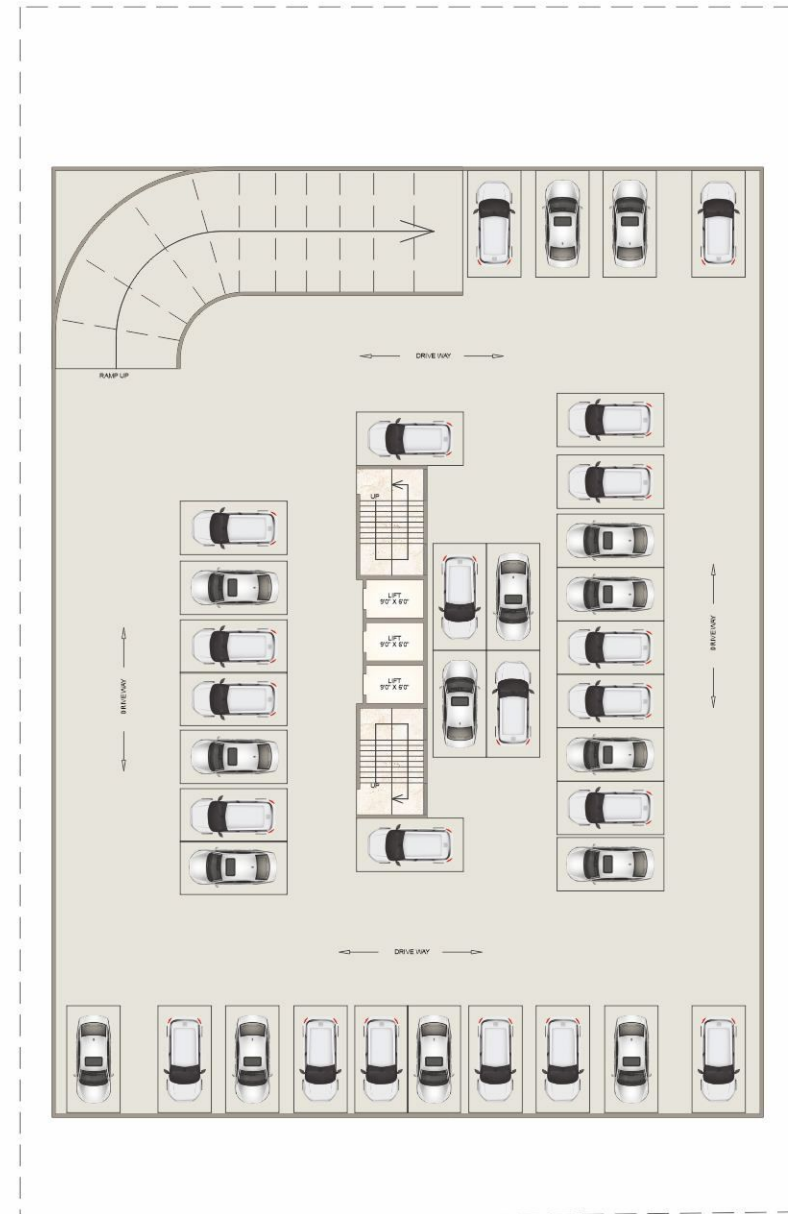

Basement Floor Plan





Ground Floor Plan

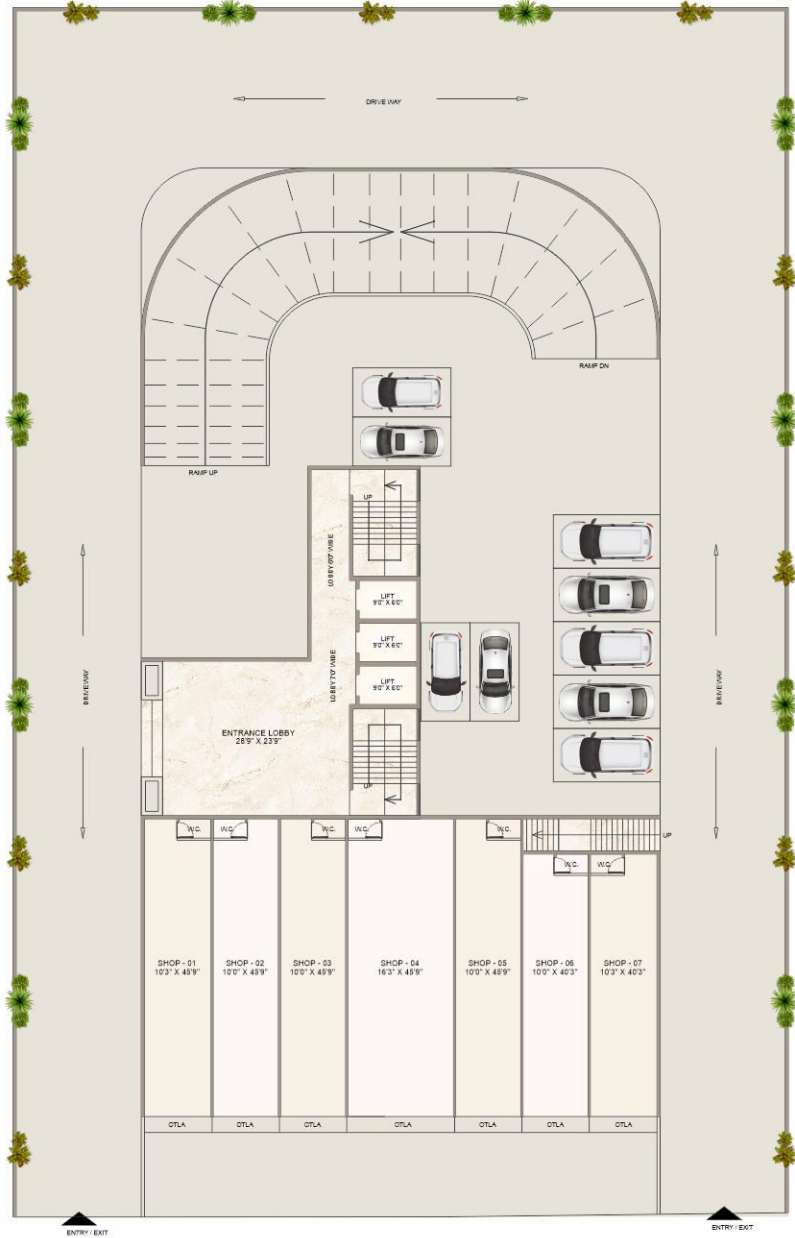

1st Floor Plan

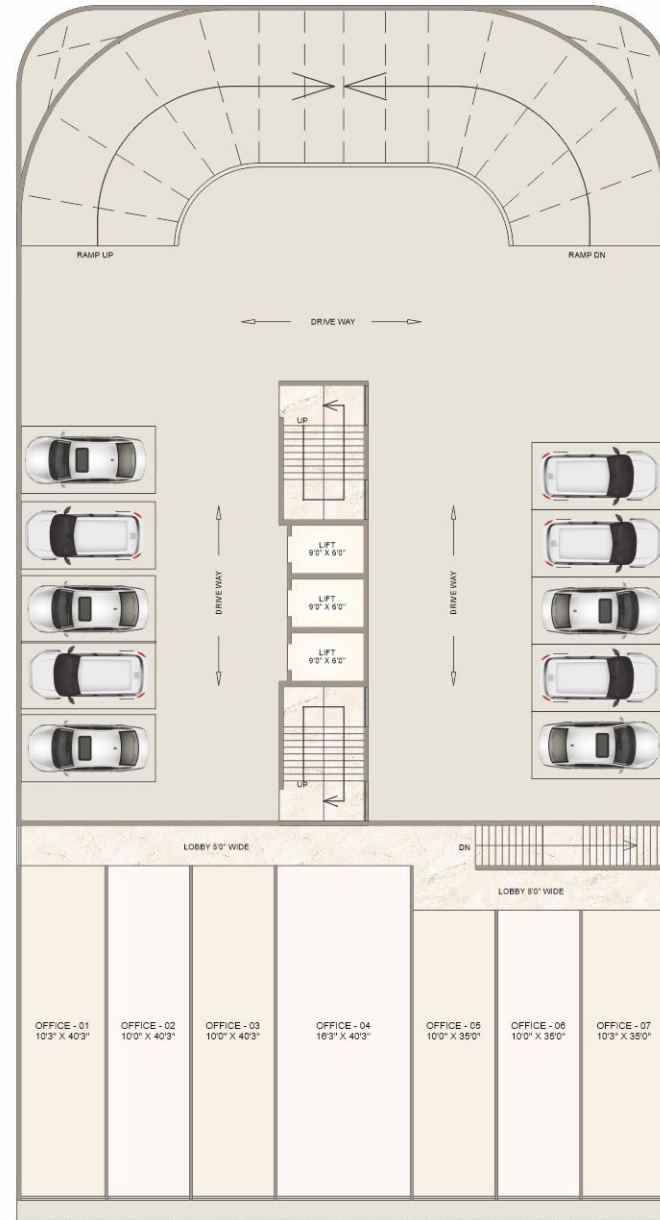



2nd Floor Plan

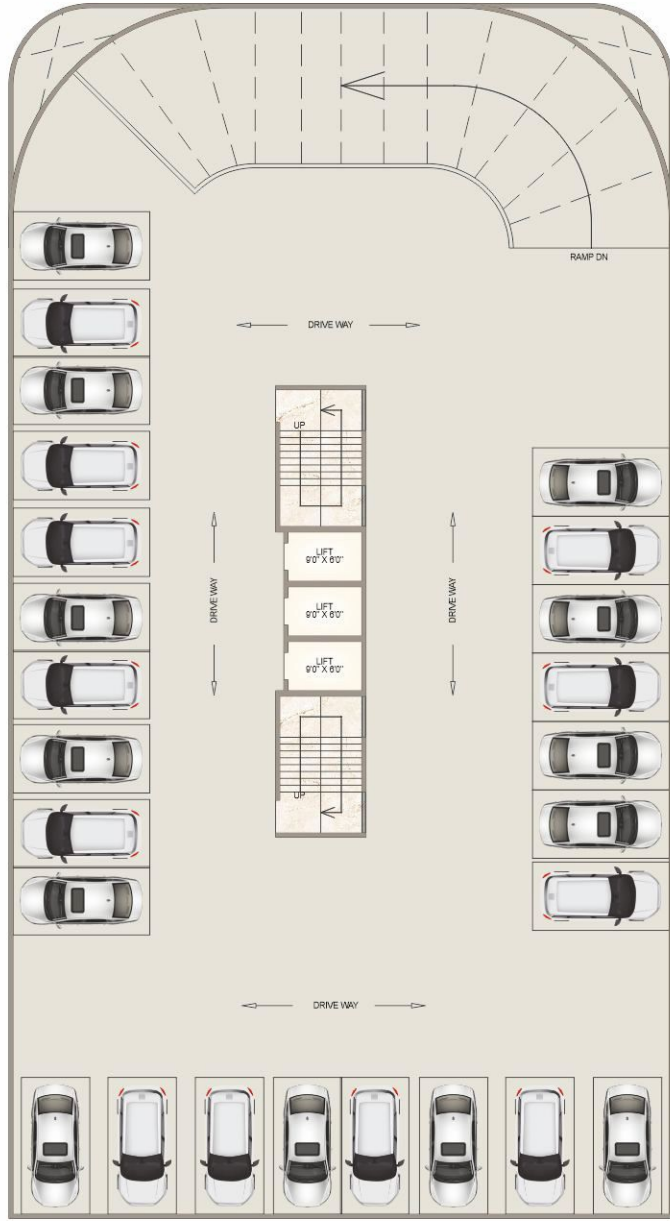

18.00 M. WIDE SERVICE ROAD



3rd Floor Plan



18.00 M. WIDE SERVICE ROAD



TYPICAL 4TH, 5TH, 6TH, 7TH, 9TH, 10TH,
12TH & 13TH FLOOR PLAN



← 18.00 M. WIDE SERVICE ROAD →



← 18.00 M. WIDE SERVICE ROAD →

8TH & 11TH FLOOR PLAN

